

## FONTES CHAVEADAS

### ■ Features

- Universal AC Input/Full range
- Class I power
- Protections : Short Circuit/Over Load/Over Voltage
- cooling by free air convection
- 100% full load burn-in test
- Approvals :UL/CE
- 2 year warranty



### SPECIFICATION

Model	KS100-05	KS100-12	KS100-15	KS100-24	KS100-36	KS100-48	
Output	DC Voltage	5V	12V	15V	24V	36 V	48V
	Rated Current	14.00A	8.33A	6.67A	4.17A	2.78A	2.08A
	Current Range	0-14.00A	0-8.33A	0-6.67A	0-4.17A	0-2.78A	0-2.08A
	Rated Power	70.00W	99.96W	100.05W	100.08W	100.08W	99.84W
	Ripple & Noise	75mVp-p	120mVp-p	150mVp-p	240mVp-p	300mVp-p	300mVp-p
	Voltage ADJ. Range	4.75-5.50V	11.40-13.20V	13.50-16.50V	21.60-26.40V	32.40-39.60V	43.20-52.80V
	Voltage Tolerance	±1.5%	±1.0%	±1.0%	±1.0%	±1.0%	±1.0%
	Line Regulation	±0.5%	±0.5%	±0.5%	±0.5%	±0.5%	±0.5%
	Load Regulation	±1.0%	±1.0%	±0.5%	±0.5%	±0.5%	±0.5%
	Set up , rise time	900ms, 60ms/230Vac at full load					
Hold Time	20ms/230Vac at full load						
Input	Voltage Range	85-264Vac 120-370Vdc					
	Frequency Range	47-63Hz					
	Efficiency	75% 230Vac	80% 230Vac	80% 230Vac	82% 230Vac	84% 230Vac	85% 230Vac
	AC current	2.0A/115Vac 1.0A/230Vac					
	Inrush Current	Cold start 30A/115Vac 60A/230Vac					
Leakage Current	<0.75mA 240Vac						
Protection	Over Load	110% -150% rated output power Hiccup mode, recovers automatically after fault condition is removed .					
	Working temp.	-10- +60°C ( refer to output derating curve )					
Environment	Working Humidity	20-90%RH non-condensing					
	StorageTemp., umidity	-20-+85°C , 10-95% RH					
	Temp. Coefficient	±0.03%/°C (0-50°C)					
	Vibration	10-500Hz, 2G 10min./1cycle , period for 60min , each along X, Y, Z axes					
	Safety Standard	UL1012, .UL60950-1 approved .					
Safety & EMC	Withstand Voltage	I/P-O/P:3KVac , I/P-FG:1.5KVac, O/P-FG:0.5KVac					
	Isolation Resistance	I/P-O/P,I/P-FG,O/P-FG:100M Ohms/500Vdc					
	EMIconduction& adiation	Compliance to EN55022 Class B					
	Harmonic Current	Compliance to EN61000-3-2,-3					
	EMS Immunity	Compliance to EN61000-4-2,3,4,5 ,EN55024					
Others	MTBF	50,000hours min at 25°C					
	Dimension	159mm*99mm*42mm					
	Weight	0.55KGS/PC					

Derating Curve

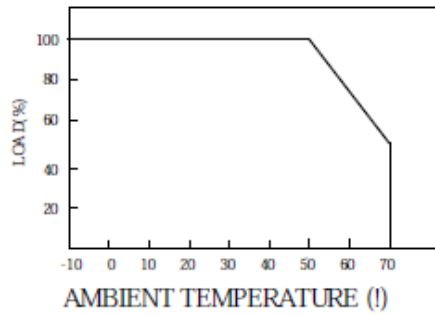

Output Derating VS Input Voltage

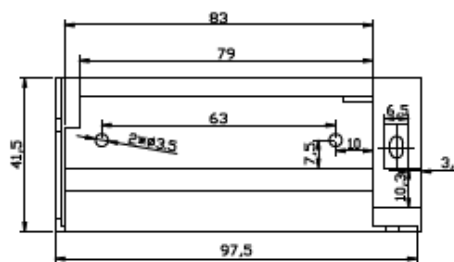
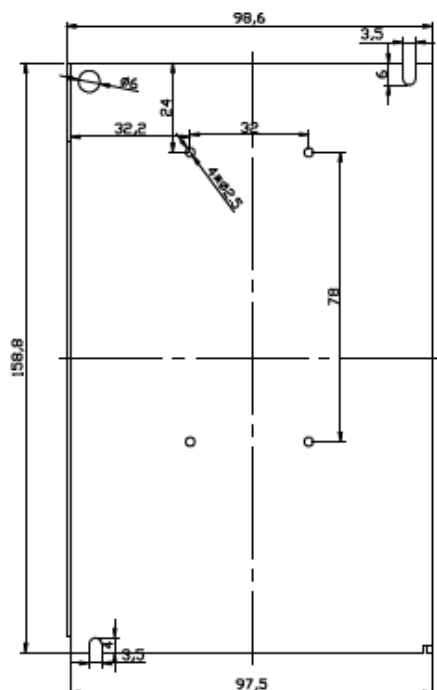
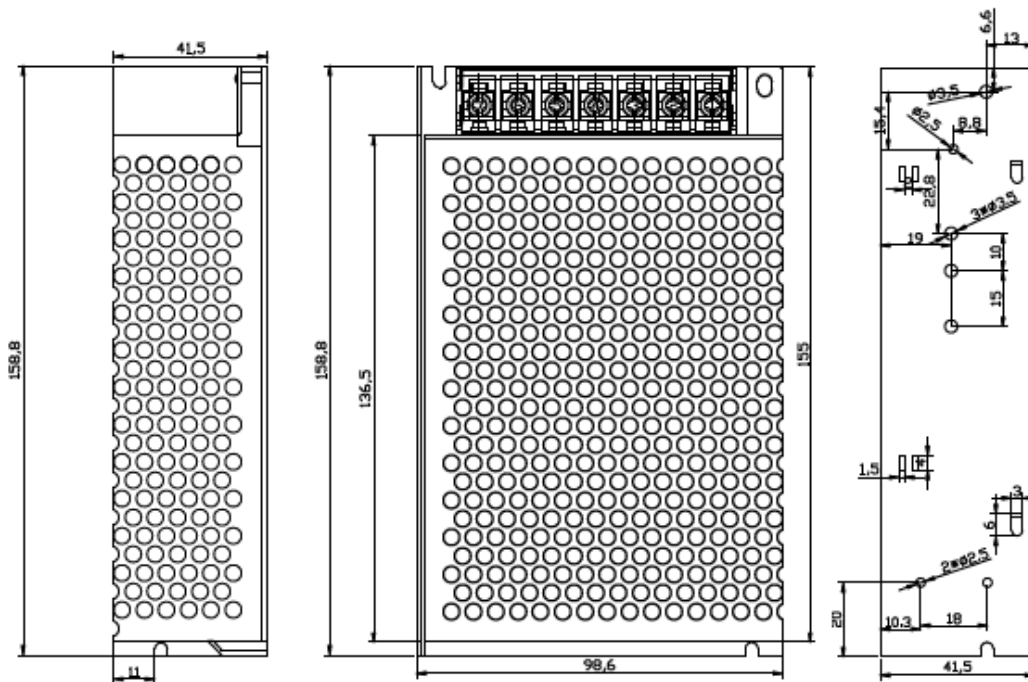
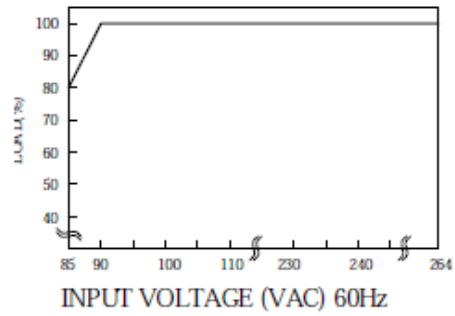

Ph	UL Ph Connections	Function
1		AC Live
2		AC Neutral
3		Ground
4		-Vout
5		-Vout
6		+Vout
7		+Vout